

Agenda
Parks Committee
CITY of ROELAND PARK
Wednesday July 10th, 2019; 6:00pm-8:00pm
Roeland Park City Hall

Committee:

(Anticipated) Guests:

Emily Hage
Jared Luebe
Russell McCorkle
Jennifer Provyn
Kathleen Whitworth
Laura Yankoviz

Donnie Scharff (Public Works Director)
Claudia McCormick (Council Advisor)
Jen Hill (Council Alt-Advisor)
Tom Madigan (Council Alt-Advisor)

SFS (City Architect)

PURPOSE. The purpose of the parks advisory committee is to make recommendations to the governing body concerning city owned parks and parkland. The committee shall also act as a tree board to recommend regulations relating to the planting of trees, shrubs and other plantings upon city owned property; to promote beautification of the city and the protection of the public health and safety; and to provide for the preservation and removal of diseased tree, shrubs and plantings.

I. Administrative

- A. Call to order
 - 1. Amendments to Agenda
 - 2. Approve June minutes
 - 3. Community Voice—incessantly barking dog(s) at R Park at night (Kathleen)

II. Old Business

- A. Budget
 - 1. Available for expenditure: \$5834.35
 - 2. Pending: -\$200 for sculpture signs; -\$3000 (approx.) for sculpture landscaping
- B. R Park
 - 1. Request to obtain City arborist consult on tree planted too close to 2-table shade structure (Laura)
 - 2. Request for removal timeline estimates for 4-5 dead trees (Laura)
 - 3. Tennis courts sign update (Donnie)
 - 4. Art panels for small shade structures (Donnie)
 - 5. Restroom size and location discussion (Jennifer)
 - a. Option-1 (648 s.f.): Full storage with expanded restroom
 - b. Option-2 (548 s.f.): Partial storage with expanded restroom that retains close-to-original footprint of non-expanded restroom (so the restroom floor plan prior to including the adult changing station)
 - c. Option-3 (492 s.f.): Nominal storage with expanded restroom
- C. Nall Park
 - 1. Arts Committee is working on potential pieces for the rain garden

Meeting Dates for 2019:

Jan 9	Feb 13	Mar 13	Apr 10	May 08	Jun 12
Jul 10	Aug 14	Sept 11	Oct 09	Nov 13	Dec 11

2. Followed-up 7/4 with Urban Trail Co on fall community work day and volunteer/orientation planning; no update yet
 3. 2019 Amenities Objective for Nall Park
 - a. Review amenities and pricing (SFS [City architect])
- D. Grants
1. AAP Dermatology grant; Walmart Foundation Community Grant Program
 - a. Both are pending finalized pavilion design and dimensions
 2. Lowes grant: Jennifer to research and report back to Committee on viability
- E. Art
1. R Park sculpture signs ordered via Moss Printing; expect installation 2nd week of July
 2. Natural landscape barrier provided by Lamp Rynearson (Attachment 1)
 - a. Plan is to coordinate small group to work on this with goal to present to Parks in August
 - b. Initial feedback:
 - i. Some of the suggested plants (e.g. the grasses) are consistent with what has been discussed
 - ii. Would like a larger planting with both shrubs and flowers
 - iii. To add interest and provide a year-round barrier some of the plants needs to be 4-season
 - iv. There is a larger goal of having the plants/design encompass both sides of the trail to include the sculpture/plaque/bench areas; while this may not be feasible at this juncture, there does need to be a barrier of some kind around the plaque and we'd like to explore plants that coordinate with the sculpture plantings

IV. New Business

- A. Roe House Play Structure
1. SFS (City architect) toured Carpenter, Granada, Nall, and R Park for consideration
 - a. Any feedback on the Community Center and Cooper Creek as locations?
 2. SFS next steps are to summarize their observations
 3. Parks reached out to Councilmember Janssen for direction (since this was his Objective); no word back, will continue moving forward and keeping Councilmember Janssen in the loop
- B. R Park
1. Recycle bin magnet; more sustainable/permanent option(s) for this and future bins (Kathleen)
 2. Brief consideration of traffic garden and playground equipment (Kathleen)
- C. Forestry/Public Works
1. Contracted forester has completed 2019 tree assessment—do we have a copy yet?
 2. Land near Horizons Academy (Jen Hill)
- D. Sweany Park (Kathleen)
1. Discussed a refresh with plan and amenities for this park
 2. The current budget season is closing
 3. Need a plan and an estimated cost if this is a goal for 2020

Meeting Dates for 2019:

Jan 9	Feb 13	Mar 13	Apr 10	May 08	Jun 12
Jul 10	Aug 14	Sept 11	Oct 09	Nov 13	Dec 11

Attachment 1: See Red Run Initial DRAFT Landscape Design

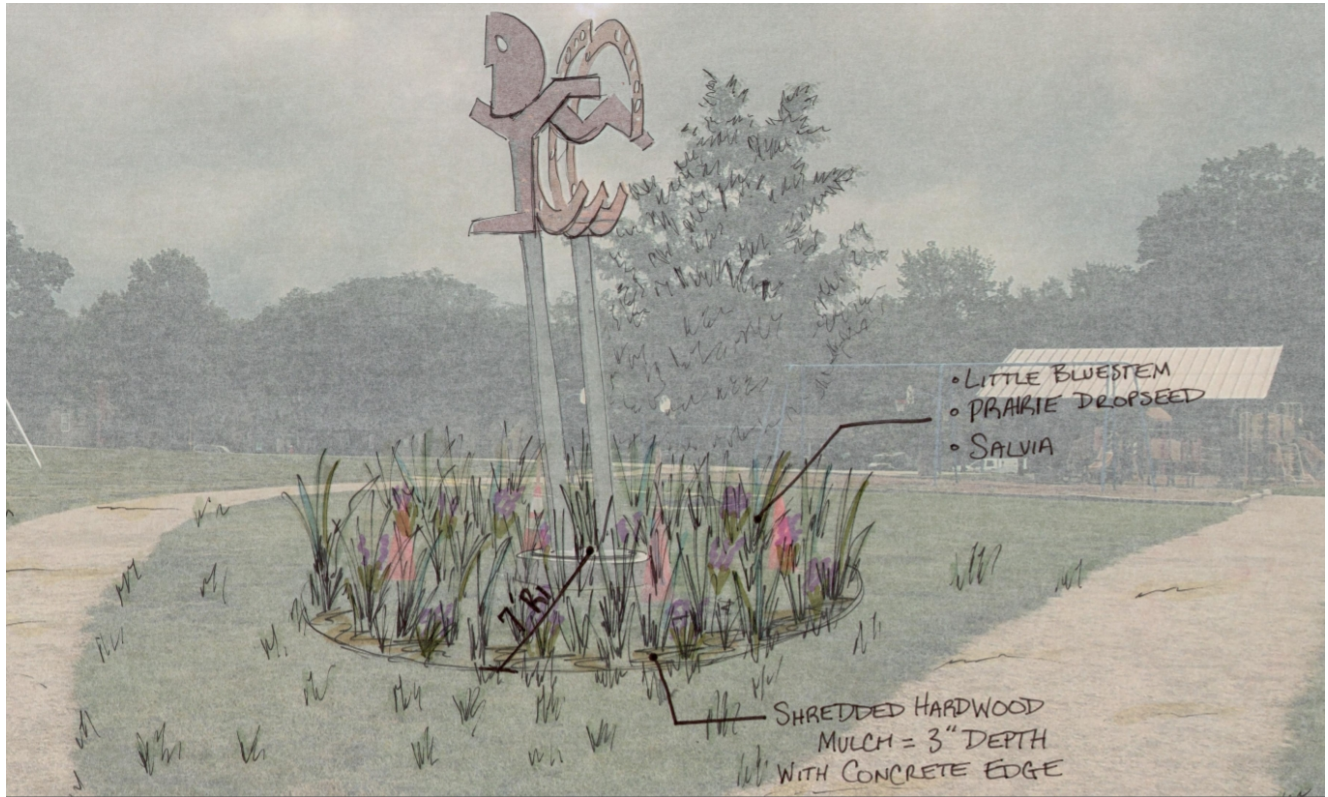

Meeting Dates for 2019:

Jan 9
Jul 10

Feb 13
Aug 14

Mar 13
Sept 11

Apr 10
Oct 09

May 08
Nov 13

Jun 12
Dec 11